

Electro-Pneumatic Positioner YT-1000R

POSITIONER



YT-1000R Electro-Pneumatic positioner is used for operation of pneumatic rotary valve actuator by means of electrical controller of control systems with an analog output signal of DC 4 to 20mA or split ranges.

- There is no resonance in the range of 5~200Hz.
- Performing 1/2 Split Control without any other substitutes.
- Easy to adjust zero and span.
- Easy to convert from Reverse Action to Direct Action or vice versa.
- Easy Feedback Connection.
- Fast and accurate response.
- Low air consumption.
- Easy to protect from hunting effect by using output orifice in small size of actuator.
- Designed as block build structure for maintenance and repair.

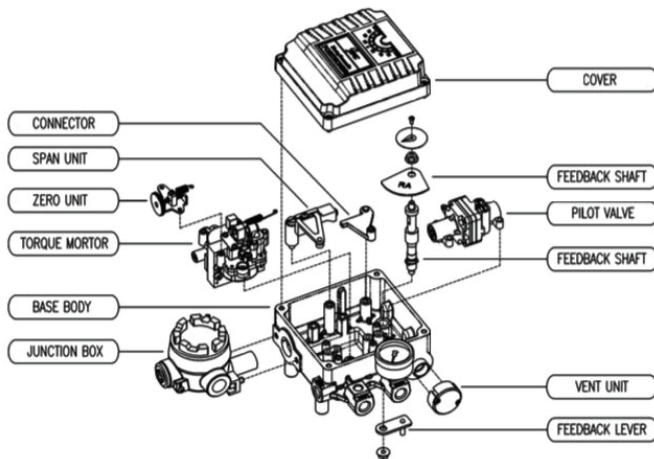

SPECIFICATION

Type Item	Single	double
input signal	4~20mA DC	
impedence	250±15Ω	
supply pressure	1.4~7.0 kgf/cm ²	
stroke	0~90°	
air connection	1/4 PT (NPT)	
gauge connection	1/8 PT (NPT)	
electric connection	1/2 PT (NPT,PF)	
explosion proof	ExdIIBT6	
protection	IP67	
amb. temp.	-20°C~60°C	
linearity	±1.0%F.S.	2.0%F.S.
hysteresis	±1.0%F.S.	
sensitivity	±0.2%F.S.	±0.5%F.S.
repeatability	±0.5%F.S.	
air consumption	3.0 LPM(sup=0.14MPa)	
flow capacity	80 LPM(sup=0.14MPa)	
material	aluminum die casting	
weight	2.8kg(6.2lb)	