

# SEALIT ePTFE

## joint sealant tape



### Technical properties

Temperature range	: - 268° to + 268°C (-450°F to +450°F)
Pressure range	: up to 3000 psi (~20Mpa)
Elongation	: 20%
Matrix tensile strength	: 30Mpa
Chemical resistance	: all media pH 0-14 except molten alkali metals and element fluorine.

### Applications

- flange
- rough or irregular surfaces
- pump and compressor housings
- heat exchangers and boiler
- manway covers
- ventilator
- food services & processes

### Features/Benefits

- self adhesive / easy to work with.
- simple and easy to install / reduces downtimes
- stock reductions / reduces inventory for cut gaskets.
- chemical and temperature resistant.

### Sealit Available Sizes

Joint sealant nominal width		Thickness length of sealant tape	
(mm)	(inches)	(mm)	(m)
3	1/8	1.5	50
5	3/16	2.0	50
7	1/4	3.0	50
10	3/8	3.0	50
14	1/2	5.0	25
17	5/8	5.0	10
20	3/4	5.0	10
25	1	10.0	5/50

## Installation

Clean the sealing surface, remove old sealing remains, and check for damage.

After the sealing surface is cleaned and fat-free, position the sealant tape in the middle of the sealing surface.

When applying the sealant tape, progressively remove the adhesive protective tape. Make sure that the adhesive is not soiled or damaged during installation, this can influence the positioning of the tape.

Position the end of the sealant tape around the starting bolt hole. Complete the installation by overlapping both ends of the sealing tape at the starting bolt hole, and cut away any excessive material.

Fragile Flanges



Option 1  
To prevent flange rotation.

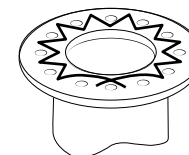

Option 2  
To minimize flange rotation.

Standard Flanges  
Flat Faced

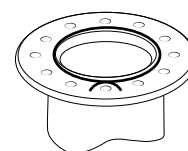

Standard Flanges  
Raised Faced

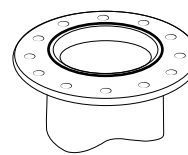

Tongue & Groove

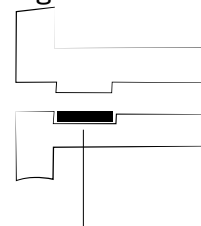

To ensure proper gasket compression, the tongue must be equal to or taller than the groove depth

SEALIT ePTFE joint sealant tape is a 100% PTFE gasket material. It comes in a soft, pliable ribbon with a self-adhesive tape. This sealant tape is a universal sealing solution on a spool, for flanges or any surfaces, which can instantly be formed in place to fit any shape regardless of its complexity. Most of users can easily and quickly form a gasket in place on the flang, and achieve significant saving in material, labor, and lead-time over traditional large cut gaskets.

## Typical size selection reference

Standard size flanges		Non-standard size flanges	
150-300 Ib ANSI flanges	Use this size	Sealing width	Use this size
1/2"-3/4"	1/8"	1/8"-1/4"	1/8"
1"-1-1/2"	3/16"	5/16"-3/8"	3/16"
2"-3-1/2"	1/4"	7/16"-5/8"	1/4"
4"-6"	3/8"	3/4"-1"	3/8"
8"-16"	1/2"	1-1/8"-1-1/2"	1/2"
18"-20"	5/8"	1-5/8"-2"	5/8"
24"-36"	3/4"	2"-2-1/2"	3/4"
36"-60"	1"	2-1/2"-3"	1"
Above 60"	2"	Above 3"	2"