

# Electro-Pneumatic Positioner YT-1000L

## POSITIONER



YT-1000L Electro Pneumatic positioner is used for operation of pneumatic valve actuators by means of electrical controller or control system with an analog output signal of DC 4 to 20mA or split ranges.

- It is designed for high durability and performance in high vibration environment.
- Durability has proven after testing of 1 million times minimum.
- Response time is very short and accurate.
- Simple part change can set 1/2 Split Range.
- It is economical due to less air-consumption.
- Direct/Reverse action can be set easily.
- Zero & Span adjustment process is simply.
- Feedback Connection is easy.

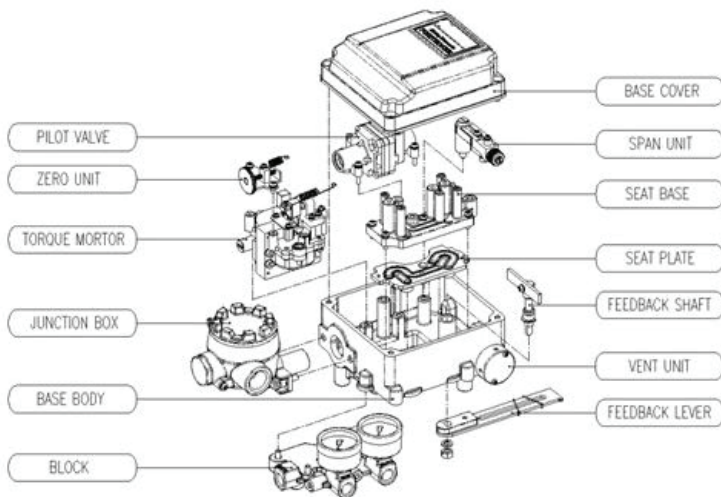

YT-1000L with Linear Actuators

### SPECIFICATION

Type Item	Single	double
input signal	4~20mA DC	
impedence	250±15Ω	
supply pressure	1.4~7.0 kgf/cm <sup>2</sup>	
stroke	10-150mm	
air connection	1/4 PT (NPT)	
gauge connection	1/8 PT (NPT)	
electric connection	1/2 PT (NPT,PF)	
explosion proof	ExdIIBT6	
protection	IP67	
amb. temp.	-20°C~60°C	
linearity	±1.0%F.S.	2.0%F.S.
hysteresis	±1.0%F.S.	
sensitivity	±0.2%F.S.	±0.5%F.S.
repeatability	±0.5%F.S.	
air consumption	3.0 LPM(sup=0.14MPa)	
flow capacity	80 LPM(sup=0.14MPa)	
material	aluminum die casting	
weight	2.7kg(6.1lb)	